

FEATURES

- Solid front with full blow back
- All stainless steel system
- 4...20 mA transmitter output

APPLICATION

- Oil & Gas applications
- High pressure applications
- Corrosive & Hazardous environments

REFERENCE

EN 837-1

Solid Front with Full Blow Back



STANDARD PARAMETERS

| | |
|---------------------|---|
| Accuracy | : CL 1.0 (Pressure Gauge), CL 0.5 (Transmitter) |
| Ambient temperature | : -40...+65°C |
| Service temperature | : 300°C max. |
| Pressure limits | : Steady pressure up to FS value : Fluctuating pressure up to 90% of FS value : Short time 1.3 x FS value for range up to 100 bar : Short time 1.15 x FS value for range above 100 bar |
| Weld joints | : TIG argon arc welding |

MATERIAL OF CONSTRUCTION

| | |
|--|--|
| Sensing element | : Bourdon Tube (<100 bar : C - type, >100 bar : Helical) |
| Case & Ring material | : AISI 304 SS (Bayonet type) |
| Bourdon tube & Shank | : AISI 316L SS (Shank welded directly to case) |
| Transmitter Sensing element & connection | : AISI 316L SS |
| Movement mechanism | : AISI 304 SS |
| Dial | : Aluminum, black graduation on white background |
| Pointer | : Micro-zero adjustable, aluminum, black powder coated |
| Gaskets & filling plug | : Neoprene |
| Window | : Shatterproof safety glass |
| Electrical Termination | : DIN connector |
| Blow off disk | : AISI 304 SS |

STANDARD SPECIFICATIONS

| | |
|------------------------|-----------------------------|
| Dial size | : DN100 / DN150 |
| Range | : -1...0...600 bar |
| Mounting pattern | : Direct, Bottom connection |
| Process connection | : 1/2" NPT (M) |
| Ingress protection | : IP 65 |
| Execution | : Dry |
| Wiring configuration | : 2 wire type |
| Supply voltage | : 24 VDC, loop powered |
| Electrical termination | : 4 pin PG 13.5 connector |

TEMPERATURE EFFECT

When temperature of the measuring system deviates from reference temperature (+20°C) max error $\pm 0.4\%$ / 10K of true scale value.

DIMENSIONAL DRAWING

Type B0

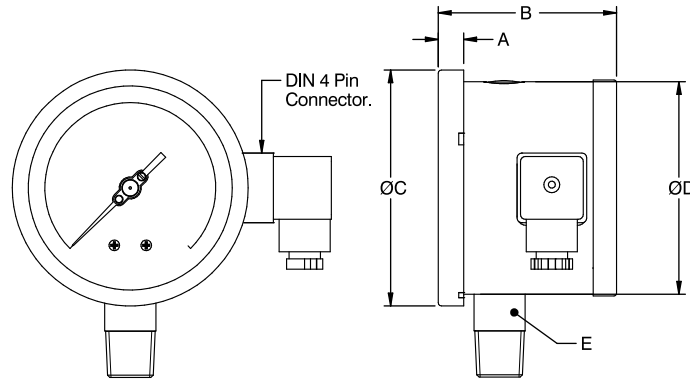

| DN | A | B | ØC | ØD | E | Weight (grams) |
|-----|----|----|-----|-----|-------|----------------|
| 100 | 12 | 84 | 111 | 100 | SQ.22 | 930 |
| 150 | 15 | 84 | 161 | 149 | SQ.22 | 1324 |

All dimensions are in mm.

ORDERING CODES

1. DIAL SIZE

| | |
|----|-------------|
| 04 | 100 mm / 4" |
| 06 | 150 mm / 6" |

06

2. RANGE

| | |
|-----|---------------------|
| XXX | Refer "Range Table" |
|-----|---------------------|

XXX

3. MOUNTING PATTERN

| | |
|----|---------------------------|
| B0 | Direct, Bottom connection |
|----|---------------------------|

B0

4. PROCESS CONNECTION

| | |
|-----|------------|
| 14B | ½" BSP (M) |
| 14N | ½" NPT (M) |

14N

5. INGRESS PROTECTION

| | |
|----|-------|
| ER | IP 65 |
|----|-------|

ER

6. EXECUTION

| | |
|----|--|
| EA | Dry |
| EK | Dampening electric filled, dielectric oil ³ |

EA

7. OTHER OPTIONS

| | |
|----|-----------------------------------|
| BA | Case & Ring in AISI 316 SS (B0) |
| EN | Dampening screw, AISI 316 SS |
| GL | AISI 316 SS movement |
| XF | SS tag plate, AISI 304 SS |
| XG | SS tag plate, AISI 316 SS |
| XR | Custom designed dial |
| XT | Dial tag marking |
| TA | 5 - point calibration certificate |
| TC | Material test certificate 3.1 |
| TM | Material test certificate 2.2 |
| TN | Tested to NACE standards |
| TO | Certification for Oxygen service |
| RA | Rubber parts, Viton |
| RN | Rubber parts, NBR |
| G6 | 6 pin, M20x1.5mm connector |

XX

Ordering Example : P503-06-XXX-B0-14N-ER-EA

NOTES

- For other connections, please contact factory.
- Electric contacts are available on request. Please contact factory for details.
- Rubber parts shall be in Viton.